

MODEL: ROUND FLOW CASSETTE WITH SENSING 50/60 Hz - FXFSQ100AVM

PROJECT NAME:

Location:	Approval:
Engineer:	Date:
Submitted to:	Construction:
Submitted by:	Unit #:
Reference:	Drawing #:

FEATURES AND BENEFITS

Dual sensors

Dual sensor and individual airflow direction control automatically provide optimal control of airflow.

Infrared presence sensor

The 4 sensors detect human presence.

Infrared floor sensor

The sensor detects the floor temperature and automatically adjusts operation of the indoor unit to reduce the temperature difference between the ceiling and the floor.

Sensing sensor low mode (default: OFF)

When there are no people in a room, the set temperature is shifted automatically.

The system automatically saves energy by detecting whether or not the room is occupied. The set temperature is shifted automatically if the room is unoccupied.

Sensing sensor stop mode (default: OFF)

When there are no people in a room, the system stops automatically.

The system automatically saves energy by detecting whether or not the room is occupied. Based on preset user conditions, the system automatically stops operation if the room is unoccupied.

Auto airflow function

With Auto airflow direction mode, flaps are controlled to deliver optimal airflow when the room is unoccupied.

When human is detected, air direction is set to "Swing (narrow)" to deliver cool air to users.

Draft prevention function

With Auto airflow direction mode, flaps are controlled to deliver optimal airflow when the room is unoccupied.

When human is detected, drafts are prevented by making the flap horizontal.

360° Airflow & Selectable Airflow Pattern

Indoor unit offers 360° airflow discharges air in all directions with more uniform temperature distribution.

Because air flows out from corner outlets, comfort spreads more widely.

Switchable fan speed: 5 steps and Auto

Control of airflow rate has been improved from 3-step to 5-step.

Auto airflow rate is newly available.

Suitable for high ceilings

Even in spaces with high ceilings, a comfortable airflow is carried down to the floor level.

EXTERNAL APPEARANCE



R-410A

Decoration Panel Lineup (Option)

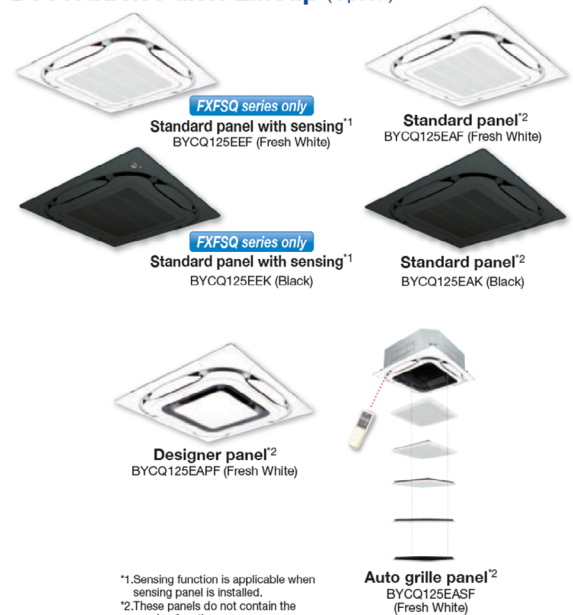

*1.Sensing function is applicable when sensing panel is installed.
*2.These panels do not contain the sensing function.

Model		FXFSQ100AVM		
Power supply		1 phase, 220-240/220-230 V, 50/60 Hz		
*1 *3 Cooling capacity	kcal/h	9,600		
	Btu/h	38,200		
	kW	11.2		
*2 *3 Heating capacity	kcal/h	10,800		
	Btu/h	42,700		
	kW	12.5		
Power input	Cooling	50 Hz	kW	0.164
		60 Hz	kW	0.164
	Heating	50 Hz	kW	0.144
		60 Hz	kW	0.144
Casing / Colour		Galvanised steel plate		
Dimensions: (HxWxD)		mm	208x840x840	
Coil (Cross fin coil)	Rows x Stages x Fin pitch	mm	2x12x1.2 (φ7)	
	Face area	m ²	0.535	
Fan	Model	QT548G15M		
	Type	Turbo fan		
	Motor output x Number of units	W	106x1	
	Airflow rate (H/HM/M/ML/L)	m ³ /min	33.5/30.5/27/23.5/21	
		l/s	559/508/450/392/350	
		cfm	1,183/1,077/953/830/741	
Drive	Direct drive			
Temperature control		Microprocessor thermostat for cooling and heating		
Sound absorbing thermal insulation material		Polyurethane form		
Piping connections	Liquid pipes	mm	φ9.5	
	Gas pipes	mm	φ15.9	
	Drain pipe	mm	φ26 (hole)	
Mass	kg	25		
*4 Sound pressure level (H/HM/M/ML/L)		dB(A)	44.0/41.0/38.0/35.0/33.0	
Safety devices		Fuse		
Refrigerant control		Electronic expansion valve		
Decoration panel (option)	Model	BYCO125EAF		
	Colour	Fresh white		
	Dimensions: (HxWxD)	mm	50x950x950	
	Air filter	Resin net (with mould resistance)		
	Mass	kg	5.5	
Standard accessories		Operation manual, Installation manual, Pattern for installation, Drain hose, Clamp metal, Washer fixing plate, Sealing pads, Clamps, Screws, Washer for hanging bracket, Insulation for fitting, Installation guide		
Drawing No.	Specification	C: 3D112945B		
	Sound level	C: 4D509733A		
Notes: *1. Indoor temp.: 27°CDB, 19°CWB / outdoor temp.: 35°CDB, 24°CWB / equivalent piping length: 7.5 m, level difference: 0 m. *2. Indoor temp.: 20°CDB, 15°CWB / outdoor temp.: 7°CDB, 6°CWB / equivalent piping length: 7.5 m, level difference: 0 m. *3. Capacities are net, including a deduction for cooling (an addition for heating) for indoor fan motor heat. *4. Anechoic chamber conversion value, measured at a point 1.5 m downward from the unit center. During actual operation, these values are normally somewhat higher as a result of ambient conditions.				

DIMENSIONS

MODEL: ROUND FLOW CASSETTE WITH SENSING 50/60 Hz - FXFSQ100AVM

Unit: mm

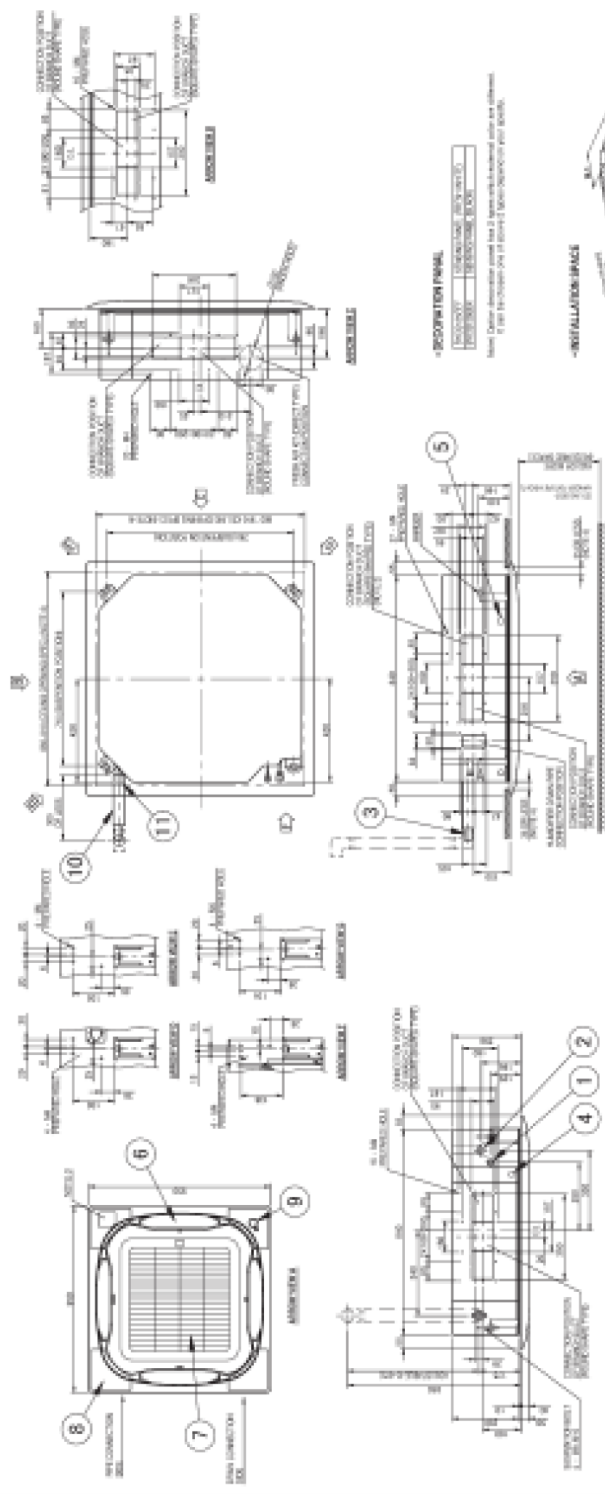

CONDENSATION PANEL

CONDENSATION PANEL: 1000x1000mm
 CONDENSATION PANEL: 1000x1000mm
 CONDENSATION PANEL: 1000x1000mm

REFILLABLE SPACE

REFILLABLE SPACE: 1000x1000mm

ASSEMBLY

ASSEMBLY: 1000x1000mm

CONDENSATION PANEL

CONDENSATION PANEL: 1000x1000mm

REFILLABLE SPACE

REFILLABLE SPACE: 1000x1000mm

ASSEMBLY

ASSEMBLY: 1000x1000mm

CONDENSATION PANEL

CONDENSATION PANEL: 1000x1000mm

REFILLABLE SPACE

REFILLABLE SPACE: 1000x1000mm

ASSEMBLY

ASSEMBLY: 1000x1000mm

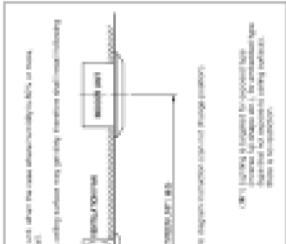

CONDENSATION PANEL

CONDENSATION PANEL: 1000x1000mm

REFILLABLE SPACE

REFILLABLE SPACE: 1000x1000mm

ASSEMBLY

ASSEMBLY: 1000x1000mm

NOTES:

- The condensation panel is made of aluminum and is designed to be installed in a ceiling. The condensation panel is designed to be installed in a ceiling.
- The condensation panel is made of aluminum and is designed to be installed in a ceiling. The condensation panel is designed to be installed in a ceiling.
- The condensation panel is made of aluminum and is designed to be installed in a ceiling. The condensation panel is designed to be installed in a ceiling.
- The condensation panel is made of aluminum and is designed to be installed in a ceiling. The condensation panel is designed to be installed in a ceiling.
- The condensation panel is made of aluminum and is designed to be installed in a ceiling. The condensation panel is designed to be installed in a ceiling.
- The condensation panel is made of aluminum and is designed to be installed in a ceiling. The condensation panel is designed to be installed in a ceiling.
- The condensation panel is made of aluminum and is designed to be installed in a ceiling. The condensation panel is designed to be installed in a ceiling.
- The condensation panel is made of aluminum and is designed to be installed in a ceiling. The condensation panel is designed to be installed in a ceiling.
- The condensation panel is made of aluminum and is designed to be installed in a ceiling. The condensation panel is designed to be installed in a ceiling.
- The condensation panel is made of aluminum and is designed to be installed in a ceiling. The condensation panel is designed to be installed in a ceiling.